

A73 gPV 1000 VDC Fuse 10x38 mm



FEATURES:

- 1000 VDC, 10x38 mm PV fuse link
- Rated Current: 1-30 A
- Rated Breaking Capacity: 30 kA
- Time Constant: 1-3 ms
- Special design with silver plated caps for high-power PV applications
- Standard: UL 248-19
- Approval: UL (File: E490190)
- BH100-01, BH100-02 holders for DIN rail mounting

ELECTRICAL SPECIFICATIONS

Part Number				Rated Current	Ampere Code	Breaking Capacity	I ² t (A ² s)		Dissipation (W)		Certifications
Cartridge	Central Mount	Level Mount	PCB Mount				Pre-Arcing	Total at 1000 V	80 % I _n	100 % I _n	
A731100700	A731100701	A731100702	A731100703	1A	1100	30 kA @1000 VDC	0.15	0.4	0.8	1.5	●
A731200700	A731200701	A731200702	A731200703	2A	1200		1.3	3.4	0.7	1.1	●
A731300700	A731300701	A731300702	A731300703	3A	1300		4	12	0.8	1.3	●
A731400700	A731400701	A731400702	A731400703	4A	1400		10	28	1.1	1.4	●
A731500700	A731500701	A731500702	A731500703	5A	1500		19	50	1.1	1.4	●
A731600700	A731600701	A731600702	A731600703	6A	1600		32	93	1.2	1.8	●
A731800700	A731800701	A731800702	A731800703	8A	1800		85	205	1.2	2.2	●
A732100700	A732100701	A732100702	A732100703	10A	2100		30	70	1.3	2.3	●
A732120700	A732120701	A732120702	A732120703	12A	2120		98	150	1.5	2.8	●
A732150700	A732150701	A732150702	A732150703	15A	2150		149	230	1.8	3.0	●
A732200700	A732200701	A732200702	A732200703	20A	2200		229	330	2.4	3.6	●
A732250700	A732250701	A732250702	A732250703	25A	2250		411	500	2.6	4.1	●
A732300700	A732300701	A732300702	A732300703	30A	2300		1200	2500	4.3	5.7	●

Note: (1) DC cold resistance are measured at <10 % of rated current in ambient temperature of 25±5 °C

(2) Typical pre-arcing I²t measured at 10*I_n current

DIMENSIONS (mm)

A73xxxx700

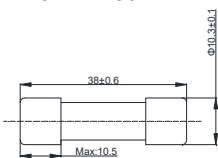

A73xxxx701

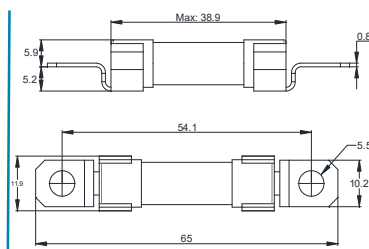

A73xxxx702

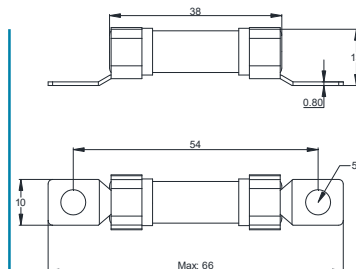

A73xxxx703

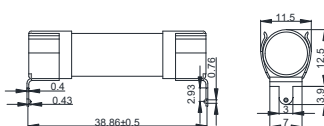

TIME VS CURRENT CHARACTERISTIC

Rated Current	100 %	135 %	200 %
1-30 A	>4 h	<1 h	<4 min

APPLICATIONS:

- PV combiner/ junction boxes
- Inverters
- Battery Charge Controllers

PART NUMBER SYSTEM

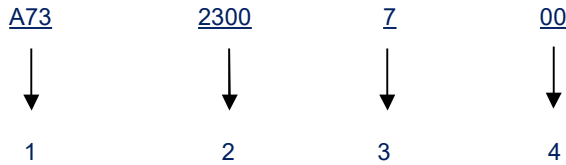

- 1Product Series A73
- 2 Ampere Code 30 A (see ampere code column of electrical specifications)
- 3Rated Voltage..... 7: 1000V
- 4 Supplementary Code 00: Cartridge; 01: Central Mount; 02: Level Mount; 03: PCB Mount;

Time Current Curve (reference)

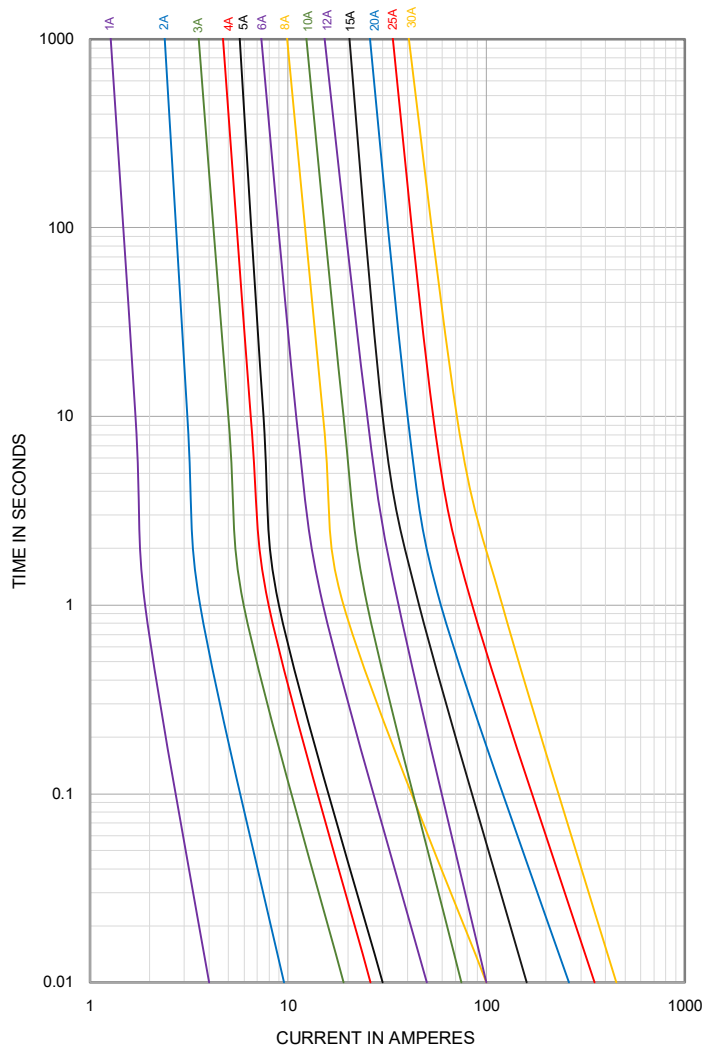

Modify Record

No.	Date	Modify Content	Version	Prepared	Check
1	2017.01.01	Initial	Rev.000	Jeffery	Ada
2	2018.06.21	Modify A73xxxx700 dimensions	Rev.006	Jeffery	Ada
3					
4					
5					
6					
7					
8					
9					
10					
11					
12					
13					
14					
15					
16					
17					
18					
19					
20					
21					
22					

ASPD Series PV Surge Protection Device



FEATURES:

- Suitable For Use in All Photovoltaic Systems
- Pre-wired Modular Complete Unit, Consisting of A Base Part and Plug-in Protection Modules
- Plug-in Protection Module, easy Installation and Maintenance
- High Energy Varistor, Response Time Less Than 25 Nanoseconds
- Optional Remote Signal Contact(FM) for Monitoring Device (Floating Changeover Contact)
- Din Rail Mounting TH35-7.5/DIN35
- In Compliance with :EN 50539-11

PRODUCT SPECIFICATIONS

ASPD PV DC Surge Protection Device		
Pole		3P
Standard		EN 50539-11
Electrical Characteristics		
Category IEC/EN		IEC II/EN2
Open Voltage	Uoc Max	1000 VDC
Max Continuous Operational Voltage	Uc	1000 VDC
Nominal Discharge Current	In(8/20)µs	20 kA
Maximum Discharge Current	I _{max} (8/20)µs	40 kA
Voltage Protection Level Up	Up	≤3.8 kV
Response Time		≤25 ns
Control and Indication		
Operating State/fault Indication		Green/Red
Plug-in Protection Module		■
Remote Signalling	Max. Working Voltage(V)	30 VDC
Contact (Optional)	Max. Working Current	1 A
Connection And Installation		
Wire	Hard cable mm ²	4-25
	Flexible cable mm ²	4-16
Terminal Screws		M5
Torque(Nm)	Main Circuit	2.5
	Remote Contact	0.25
Degree of Protection		IP20
Installation Environment		
Operating Temperature Range (TU)		-40°C to +80°C
For Mounting on		TH35-7.5/DIN35
Relative Humidity		30% to 90%
Weight kg		0.36

Model Numbering Definitions

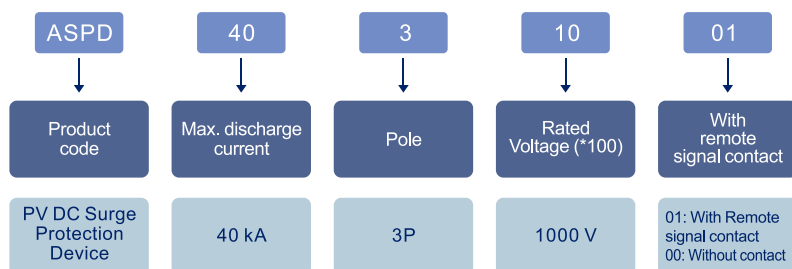

PRODUCT ARCHITECTURE

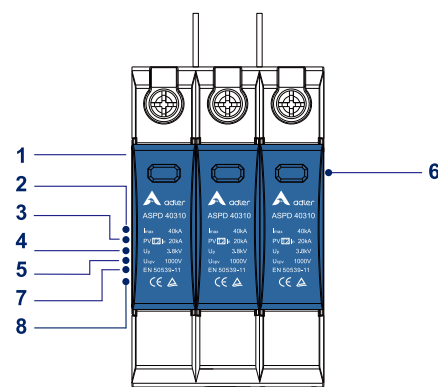

- 1 Brand
- 2 Max. Discharge Current I_{max}
- 3 Nominal Discharge Current I_n
- 4 Voltage Protection Level U_p
- 5 Max. Continuous Operating Voltage U_{cpv}
- 6 Indicator
- 7 Standard Code
- 8 Certificate Symbol

Application

ADLER's ASPD Series PV DC Surge Protection Devices are designed and manufactured complying to PV standard EN50539-11. It is widely used in PV DC combiner boxes, inverters, controllers and DC cabinets. With a rated voltage of 1000 VDC and a maximum discharge current of 40 kA, the integrated high-energy varistor provides highly effective protection against lightning and surge voltages.



adler®

CONNECTION DIAGRAM

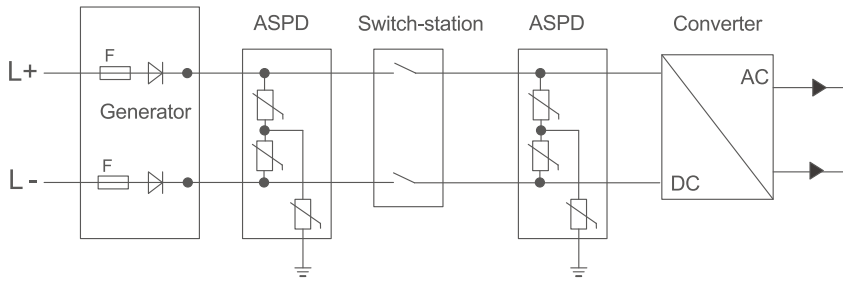

WIRING INSTRUCTIONS

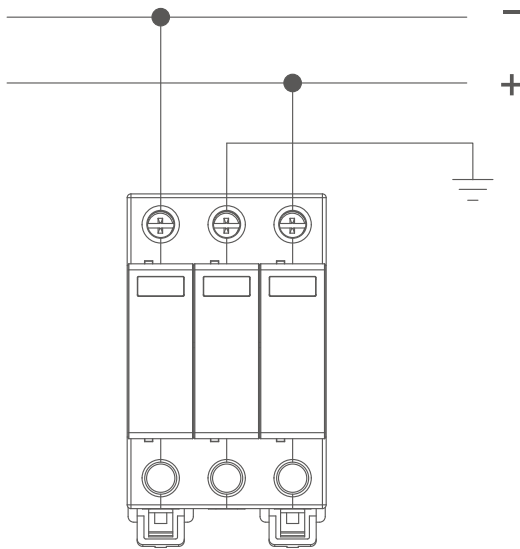

DIMENSIONS(mm)

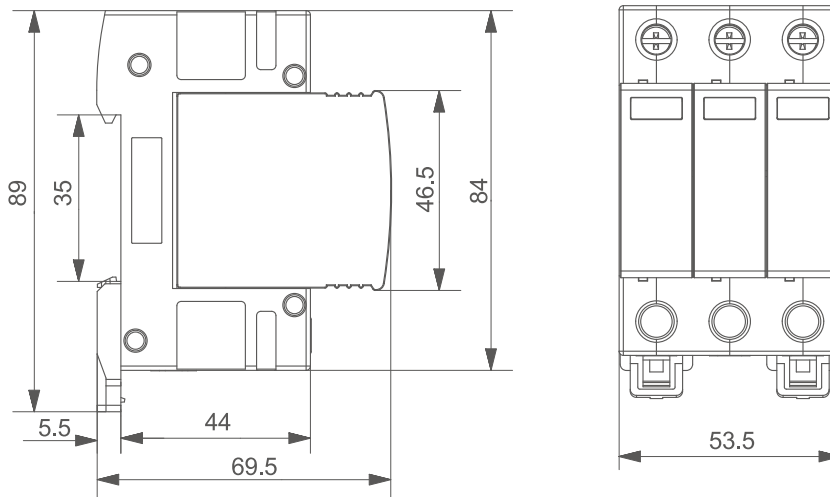

BH100-02 1000V / 1100V Fuse Holder



FEATURES:

ADLER BH100-02 touch safe fuse holders are designed for all standard 10x38mm PV fuses such as ADLER A73 / A83 series.

Note: SCCR is limited to the interrupting rating of the installed fuse or 30kA, which ever is less.

DESCRIPTION:

BH100-02 touch safe holders are designed for 10x38mm DC midget fuses, especially for use with photovoltaic equipment. 10x38mm Fuse Holder With Indicator Light

SPECIFICATIONS:

- Rated Voltage: 1000 VDC / 1100 VDC
- Rated Current: up to 30 A / 32 A
- Short Circuit Current Rating(SCCR): DC 30kA@1000VDC / 20kA@1100VDC
- Standards: UL 4248-18
- Wire Range: 18 - 8 AWG
- Max. Torque: 3.4 N·m
- Max. Dissipation: 6W
- Operation Temperature: -40°C to +130°C
- Material Flammability: UL 94-V0
- Mounting: DIN Rail mounting
- Degree of protection IP20
- UL Listed File: E486822

DIMENSIONS: mm

